

WP-902 Carriage Hardware

WP-902 Parts Provided:

1. Knee (4)
2. R.H. Knee Guide (4)
3. L.H. Knee Guide (4)
4. Dog (4)
5. Dog Head (4)
6. Rack (4)
7. Axle Bearing (10)
8. Plain Wheel (5)
9. Double Flange Wheel (5)
10. Shaft Coupling (2)
11. Stop Sector
12. Detent Asm.
13. Set Ratchet
14. Set Lever
15. Reset Lever and Ratchet

Additional Items Needed:

- | | |
|-------------------|--------------------|
| A. Dog Head Lever | .020" Brass Wire |
| B. Set Shaft | .045" Brass Wire |
| C. Axle | .045" Brass Wire |
| D. Sill | 6" x 10" Stripwood |
| E. Cross Member | 6" x 8" Stripwood |
| F. Rail | Code 40 or 55 |
| G. Stringer | 6" x 6" Stripwood |
| H. Set Rod | .015" Brass Wire |
| I. Tension Rod | .015" Brass Wire |

Stripwood for Carriage - see template

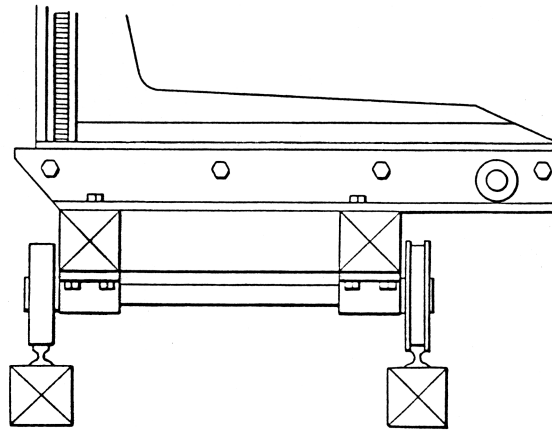
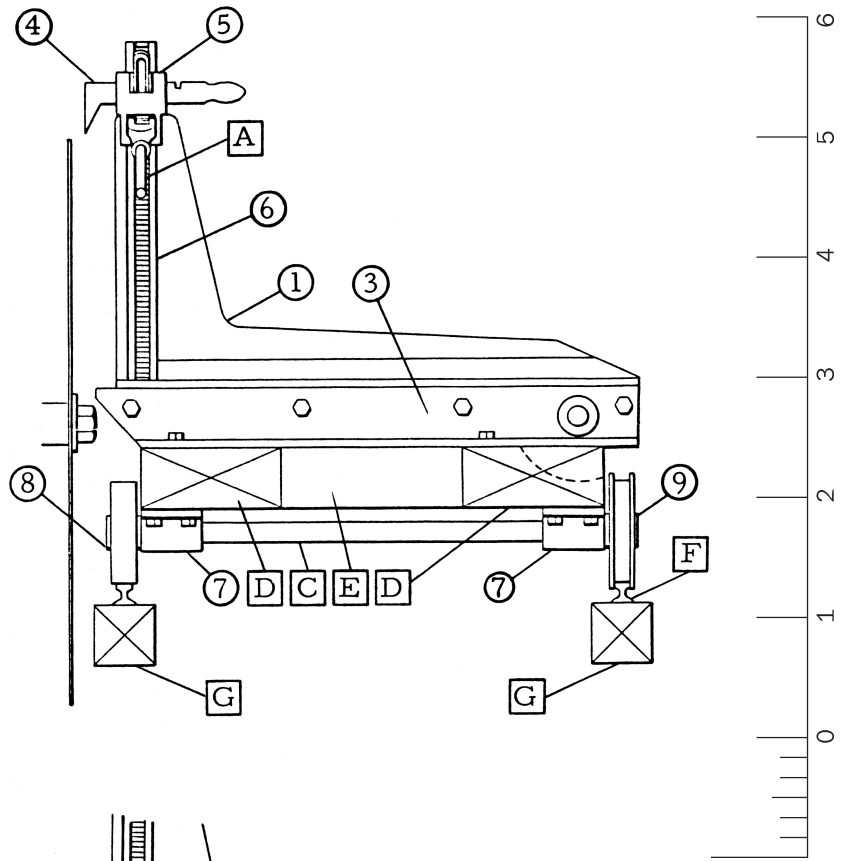

SierraWestTM
O Scale Classics

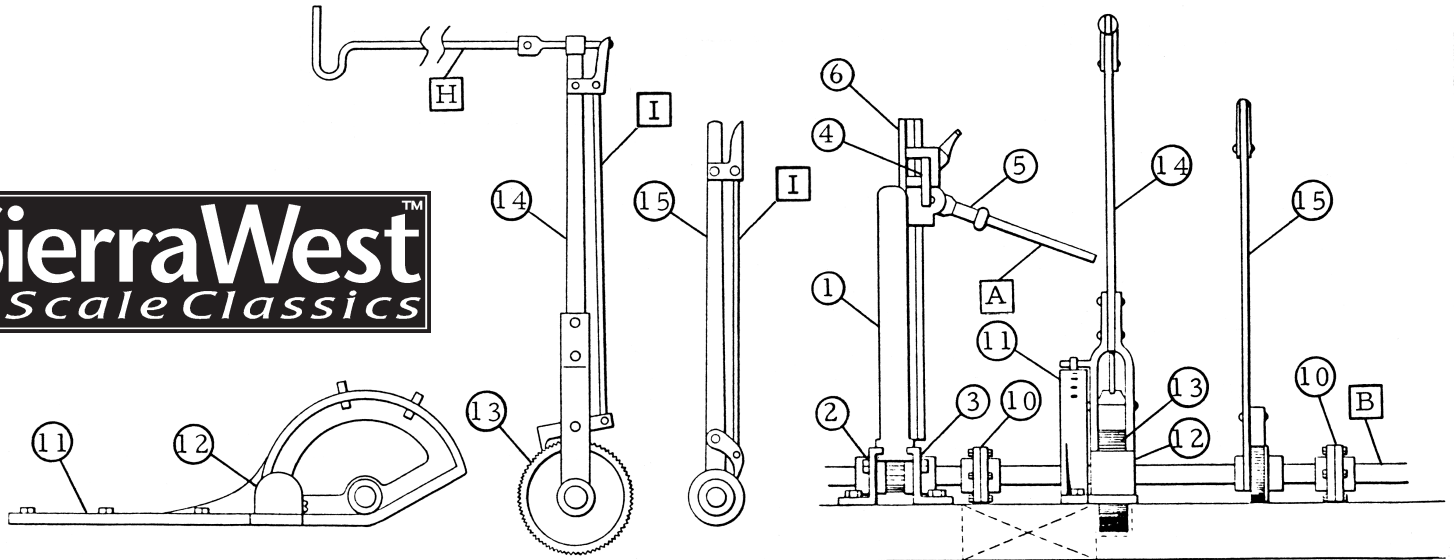

The hardware is suitable for light and medium weight carriages from 10 feet to 24 feet in length with track gauges from 36" to 48". Sectional views of minimum and maximum widths are shown on page 9.

- Rear sills on carriages wider than 38" will have to be notched to clear set ratchet.
- Reset lever (15) is often omitted from light carriages.
- Carriages with setters platform do not use set rod (H) - lug can be removed from set lever
- Stop sector (11) is usually mounted on a cross member between the first and second knees with the set lever, shaft coupling, and reset lever placed to suit.

100% Full Size Templates

12' x 34" Carriage (36" Gauge)

All Frame Members 6" x 6"

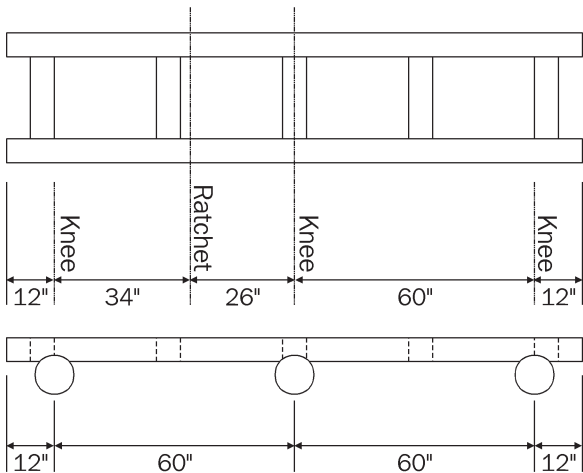

16" x 40" Carriage (42" Gauge)

All Frame Members 6" x 6"

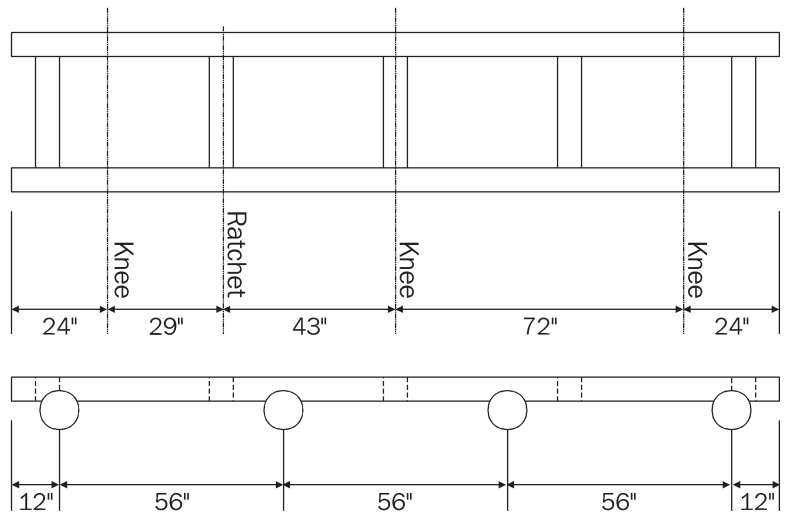

22' x 46" Carriage (48" Gauge) with Setters Platform

